



ORDINANCE NUMBER 24-2014

AN ORDINANCE TO CHANGE THE ZONING CLASSIFICATION OF PROPERTY OWNED BY WYATT REALTY INVESTMENT OPPORTUNITY FUND LTD LOCATED AT BRUSHY CREEK ROAD AND BUNCOMBE ROAD FROM C-2 (COMMERCIAL) TO DRD (DESIGN REVIEW DISTRICT).

The City Council of Greer makes the following findings:

This ordinance pertains to a certain property owned by the Wyatt Realty Investment Opportunity Fund Ltd. located at Brushy Creek Road and Buncombe Road and more clearly identified by the attached City of Greer Map specifying Greenville County Parcel Number G005000100700 containing approximately 18.00 acres attached hereto marked as Exhibit A.

1. The owner desires to change the zoning classification of the property and has shown the need for such use to the Greer Planning Commission at a public hearing held on September 15, 2014.
2. To accomplish the desired change in use in the most effective manner, the zoning classifications should be changed to DRD (Design Review District).
3. The proposed use is in keeping with the general character of the surrounding property.

NOW, THEREFORE, be it ordained by the Mayor and Council of the City of Greer, South Carolina, as follows:

The zoning classification of the property located at Brushy Creek Road and Buncombe Road and more particularly identified by the attached City of Greer Map specifying Greenville County Parcel Number G005000100700 containing approximately 18.00 acres attached hereto as Exhibit A shall be changed from C-2 (Commercial) to DRD (Design Review District).

This ordinance shall be effective immediately upon second reading approval.

CITY OF GREER, SOUTH CAROLINA

Richard W. Danner, Mayor

ATTEST:

Tammela Duncan, Municipal Clerk

Introduced by: Councilman Wryley Bettis

First Reading: September 23, 2014

Second and
Final Reading: October 14, 2014

Approved as to Form:



John B. Duggan
City Attorney

EXHIBIT
A



RZ 2014-15

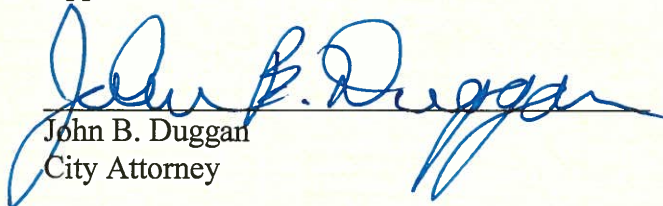
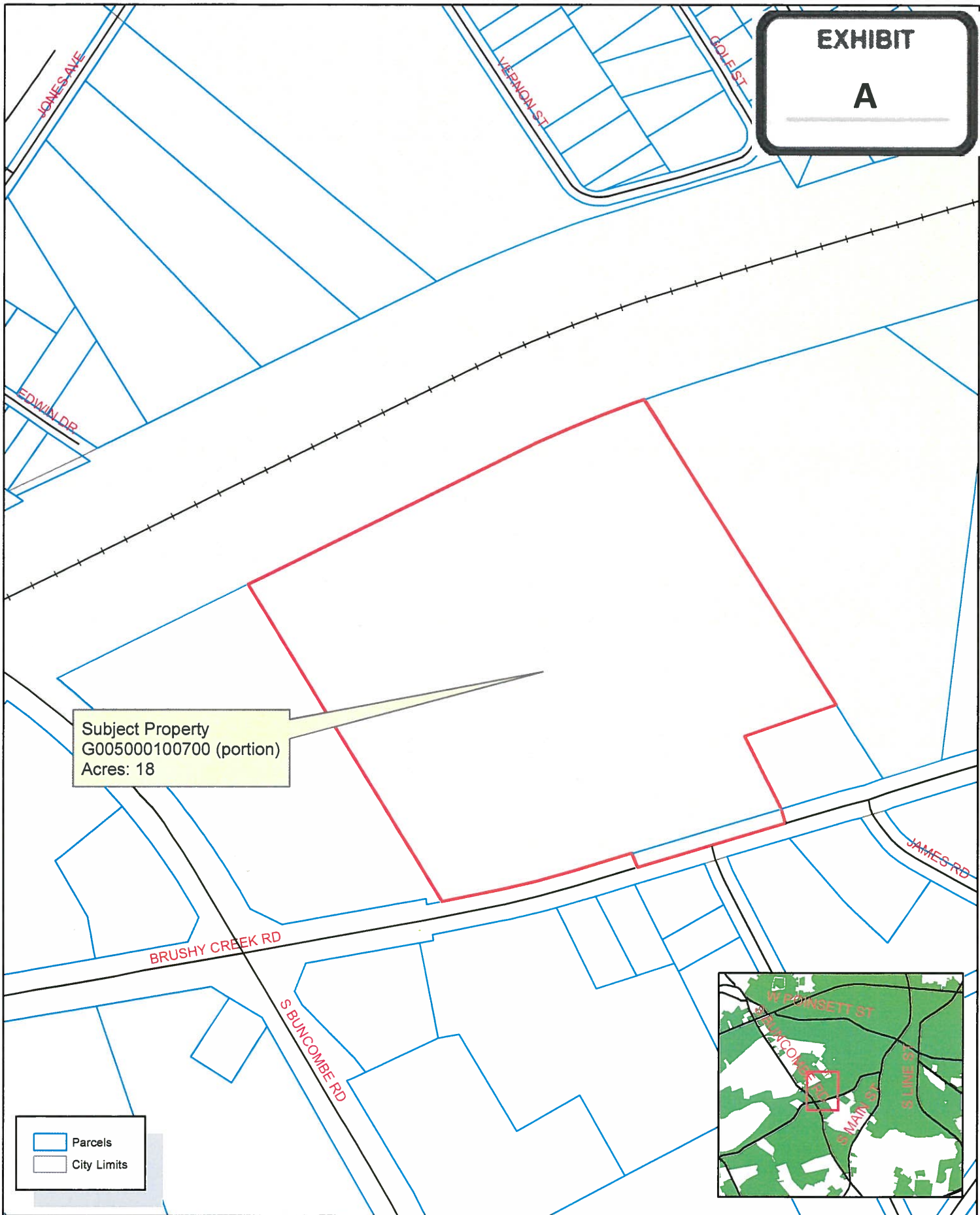
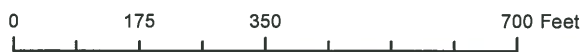

The City of Greer Planning/Zoning Department does not guarantee the accuracy or the correctness of this map nor assumes any legal responsibility for the information contained on it. This map is not a legal document. This map is based on the South Carolina State Plane Coordinate System using the 1983 adjustment of the North American Datum. All rights reserved. No part of this map may be reproduced or used in any form or by any means without the expressed written consent of the City of Greer Planning/Zoning Department.